

PL-M

THROUGH CONNECTOR, PRE-INSULATED WITH PVC, FOR COPPER CONDUCTORS

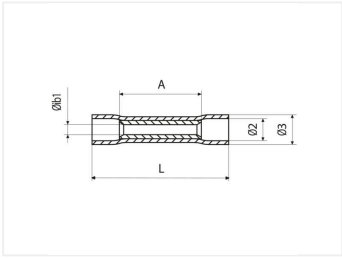

CERTIFICATIONS & APPROVALS

 UL (cULus)

Features

TECHNICAL INFORMATION

Minimum operating temperature	-20 °C
Maximum operating temperature	80 °C
Threshold of operating temperature for short periods	90 °C
Barrel reinforcement ring	No
Central stop	Yes
Markings found	factory mark; cembre catalogue number
Type	singolo
Type of insulation	totale
Easy insertion input	No
Reinforced with anti-vibration collar	No

LOGISTIC

Type of packaging	; box
Unit in minimal packaging	100 PCE
Minimum order quantity	100 PCE
Customs code	85369010

MATERIAL COMPOSITION AND TREATMENTS

Conductor body material	Electrolitic copper with purity above 99,95%
Minimum thickness of the surface coating of the conducting body	3 µm
Surface treatment of the conductor body	tin plating
Insulated cover material	PVC
Annealing	Yes
Internal surface of the barrel	smooth
Halogen free	No

CLASSIFICATION AND DATA ORDERING

ETIM Class 7	Crimp splices for copper conductor [EC001059]
--------------	---

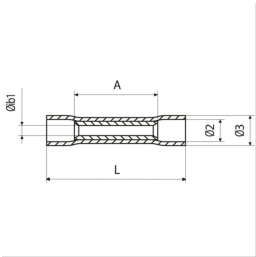

tipo	Type of connector	Reference standard	Insulated cover colour	Greatest internal diameter of the barrel [mm]	Smallest internal diameter of the barrel [mm]	Range of cable cross section [mm²]	L [mm]	Gross weight [g]	A [mm]	C [mm]	Ø2 [mm]	Ø3 [mm]	Ø [mm]	Cable stripping length [mm]	Unit in standard packaging [pce]
PL01-M	pass-through parallel connector		Green RAL 6018	2.15	1.15	0.2 ÷ 0.5	25	0,676	15	26	3	3.8	1.15	16.5	3,000
PL03-M	butt connector; pass-through parallel connector	UL 486A-486B; UL 486C	Red RAL 3000	3.3	1.8	0.25 ÷ 1.5	25	1,343	15	26	4	4.7	1.8	16.5	1,000
PL06-M	butt connector; pass-through parallel connector	UL 486A-486B; UL 486C	Blue RAL 5015	4	2.42	1.5 ÷ 2.5	25	1,595	15	26	5	5.45	2.42	16.5	1,500
PL1-M	pass-through parallel connector	UL 486A-486B; UL 486C	Yellow RAL 1021	5.25	3.6	4 ÷ 6	32	2,708	16	33	6.5	7	3.6	17.6	500